

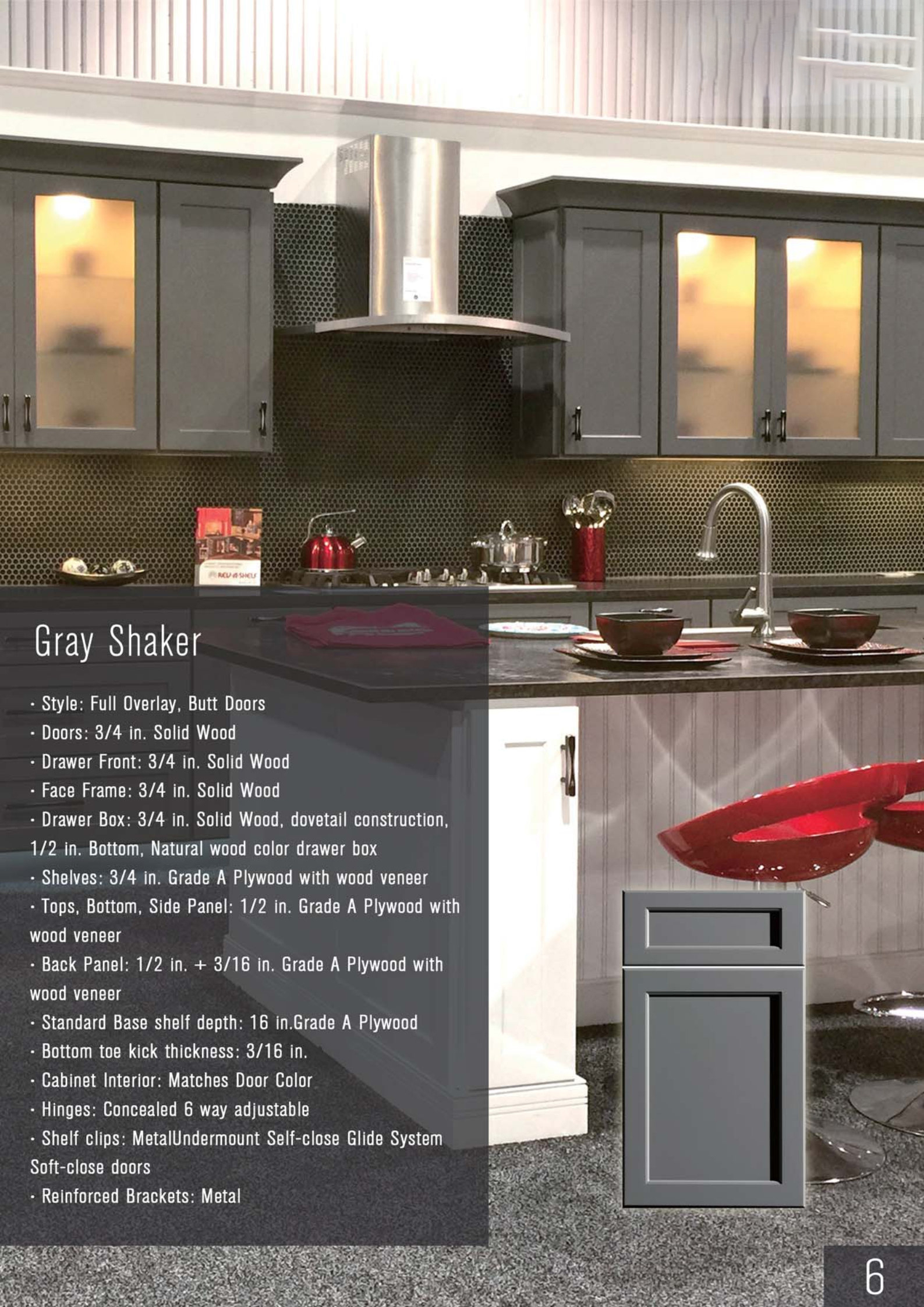

## Ivory White

- Style: Full Overlay, Butt Doors
- Doors: 3/4 in. Solid Wood
- Drawer Front: 3/4 in. Solid Wood
- Face Frame: 3/4 in. Solid Wood
- Drawer Box: 3/4 in. Solid Wood, dovetail construction, 1/2 in. Bottom, Natural wood color drawer box
- Shelves: 3/4 in. Grade A Plywood with wood veneer
- Tops, Bottom, Side Panel: 1/2 in. Grade A Plywood with wood veneer
- Back Panel: 1/2 in. + 3/16 in. Grade A Plywood with wood veneer
- Standard Base shelf depth: 16 in. Grade A Plywood
- Bottom toe kick thickness: 3/16 in.
- Cabinet Interior: Matches Door Color
- Hinges: Concealed 6 way adjustable
- Shelf clips: Metal Undermount Self-close Glide System
- Soft-close doors
- Reinforced Brackets: Metal



## Gray Shaker

- Style: Full Overlay, Butt Doors
- Doors: 3/4 in. Solid Wood
- Drawer Front: 3/4 in. Solid Wood
- Face Frame: 3/4 in. Solid Wood
- Drawer Box: 3/4 in. Solid Wood, dovetail construction, 1/2 in. Bottom, Natural wood color drawer box
- Shelves: 3/4 in. Grade A Plywood with wood veneer
- Tops, Bottom, Side Panel: 1/2 in. Grade A Plywood with wood veneer
- Back Panel: 1/2 in. + 3/16 in. Grade A Plywood with wood veneer
- Standard Base shelf depth: 16 in. Grade A Plywood
- Bottom toe kick thickness: 3/16 in.
- Cabinet Interior: Matches Door Color
- Hinges: Concealed 6 way adjustable
- Shelf clips: Metal Undermount Self-close Glide System
- Soft-close doors
- Reinforced Brackets: Metal



## Espresso

- Style: Full Overlay, Butt Doors
- Doors: 3/4 in. Solid Wood
- Drawer Front: 3/4 in. Solid Wood
- Face Frame: 3/4 in. Solid Wood
- Drawer Box: 3/4 in. Solid Wood, dovetail construction, 1/2 in. Bottom, Natural wood color drawer box
- Shelves: 3/4 in. Grade A Plywood with wood veneer
- Tops, Bottom, Side Panel: 1/2 in. Grade A Plywood with wood veneer
- Back Panel: 1/2 in. + 3/16 in. Grade A Plywood with wood veneer
- Standard Base shelf depth: 16 in. Grade A Plywood
- Bottom toe kick thickness: 3/16 in.
- Cabinet Interior: Matches Door Color
- Hinges: Concealed 6 way adjustable
- Shelf clips: Metal Undermount Self-close Glide System
- Soft-close doors
- Reinforced Brackets: Metal



## Pecan

- Style: Full Overlay, Butt Doors
- Doors: 3/4 in. Solid Wood
- Drawer Front: 3/4 in. Solid Wood
- Face Frame: 3/4 in. Solid Wood
- Drawer Box: 3/4 in. Solid Wood, dovetail construction, 1/2 in. Bottom, Natural wood color drawer box
- Shelves: 3/4 in. Grade A Plywood with wood veneer
- Tops, Bottom, Side Panel: 1/2 in. Grade A Plywood with wood veneer
- Back Panel: 1/2 in. + 3/16 in. Grade A Plywood with wood veneer
- Standard Base shelf depth: 16 in. Grade A Plywood
- Bottom toe kick thickness: 3/16 in.
- Cabinet Interior: Matches Door Color
- Hinges: Concealed 6 way adjustable
- Shelf clips: Metal Undermount Self-close Glide System
- Soft-close doors
- Reinforced Brackets: Metal



## Raised Panel

- Style: Full Overlay, Butt Doors
- Doors: 3/4 in. Solid Wood
- Drawer Front: 3/4 in. Solid Wood
- Face Frame: 3/4 in. Solid Wood
- Drawer Box: 3/4 in. Solid Wood, dovetail construction, 1/2 in. Bottom, Natural wood color drawer box
- Shelves: 3/4 in. Grade A Plywood with wood veneer
- Tops, Bottom, Side Panel: 1/2 in. Grade A Plywood with wood veneer
- Back Panel: 1/2 in. + 3/16 in. Grade A Plywood with wood veneer
- Standard Base shelf depth: 16 in. Grade A Plywood
- Bottom toe kick thickness: 3/16 in.
- Cabinet Interior: Matches Door Color
- Hinges: Concealed 6 way adjustable
- Shelf clips: Metal Undermount Self-close Glide System
- Soft-close doors
- Reinforced Brackets: Metal



## White Shaker

- Style: Full Overlay, Butt Doors
- Doors: 3/4 in. Solid Wood
- Drawer Front: 3/4 in. Solid Wood
- Face Frame: 3/4 in. Solid Wood
- Drawer Box: 3/4 in. Solid Wood, dovetail construction, 1/2 in. Bottom, Natural wood color drawer box
- Shelves: 3/4 in. Grade A Plywood with wood veneer
- Tops, Bottom, Side Panel: 1/2 in. Grade A Plywood with wood veneer
- Back Panel: 1/2 in. + 3/16 in. Grade A Plywood with wood veneer
- Standard Base shelf depth: 16 in. Grade A Plywood
- Bottom toe kick thickness: 3/16 in.
- Cabinet Interior: Matches Door Color
- Hinges: Concealed 6 way adjustable
- Shelf clips: Metal Undermount Self-close Glide System
- Soft-close doors
- Reinforced Brackets: Metal

# ELITE SERIES



*Espresso Shaker*



*Ivory White*



*Dark Caramel*



*Grey Shaker*

# PREMIERE SERIES



*New York Glaze*



*White Shaker*



*Coffee*



*Pecan*

# VALUE SERIES



*Port*



*Cinnamon*

# PORT



Front



Side



Details

# BROWN CHOCOLATE



Front



Side



Details



# SUNTAN



Front



Side



Details

# CINNAMON



Front



Side



Details

# RAISED PANEL



Front



Side



Details

# SHAKER



Front



Side



Details

# MAPLE SHAKER



Front



Side



Details

# WHITE SHAKER



Front



Side



Details

# IVORY WHITE



Front



Side



Details

# PURE WHITE SHAKER



Front



Side



Details

# ALMOND SHAKER



Front



Side



Details

# CHERRY SHAKER



Front



Side



Details

# COFFEE



Front



Side



Details

# NEW YORK GLAZE



Front



Side



Details

# SLAB DOOR



Front



Side



Details

# ANTIQUE WHITE



Front



Side



Details

# VANITY 001



Front



Details

# VANITY 002



Front

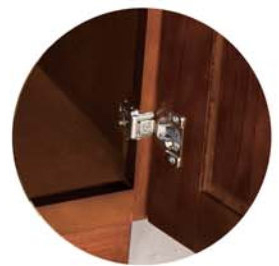

Details



# VANITY 003



Front



Details

# VANITY 004



Front



Details

# VANITY 005



Front



Details

# VANITY 006



Front

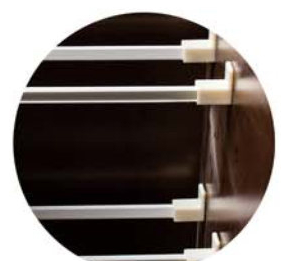

Details

# PROFESSIONAL DRAWING

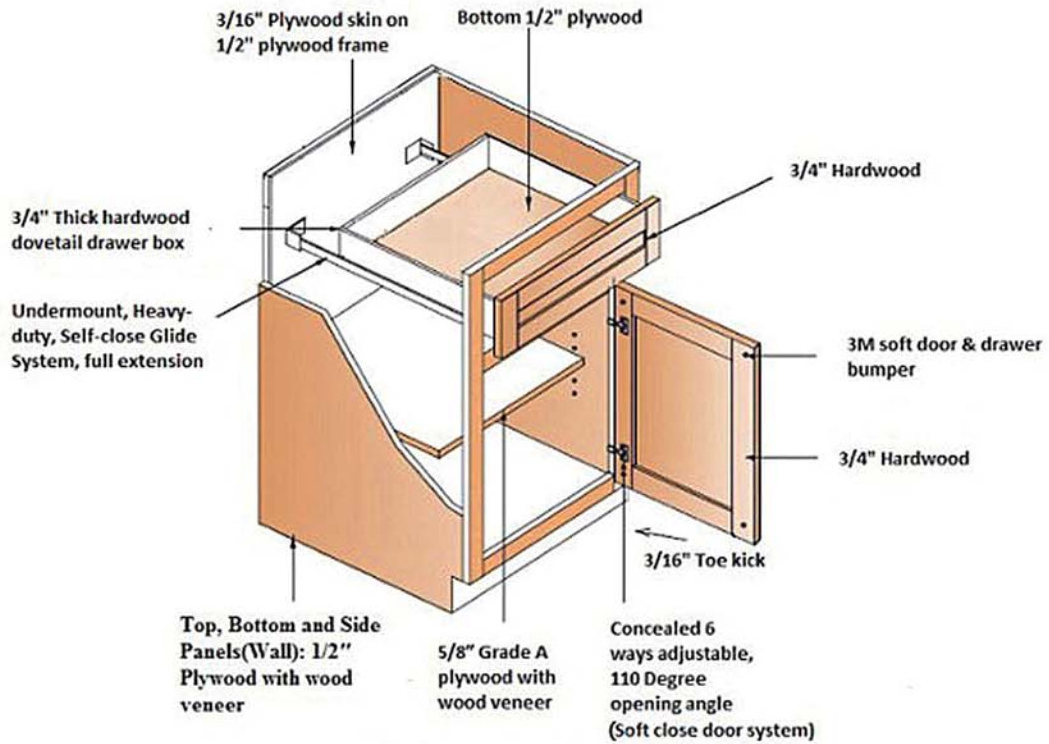

**Tip:** Soft close door system optional

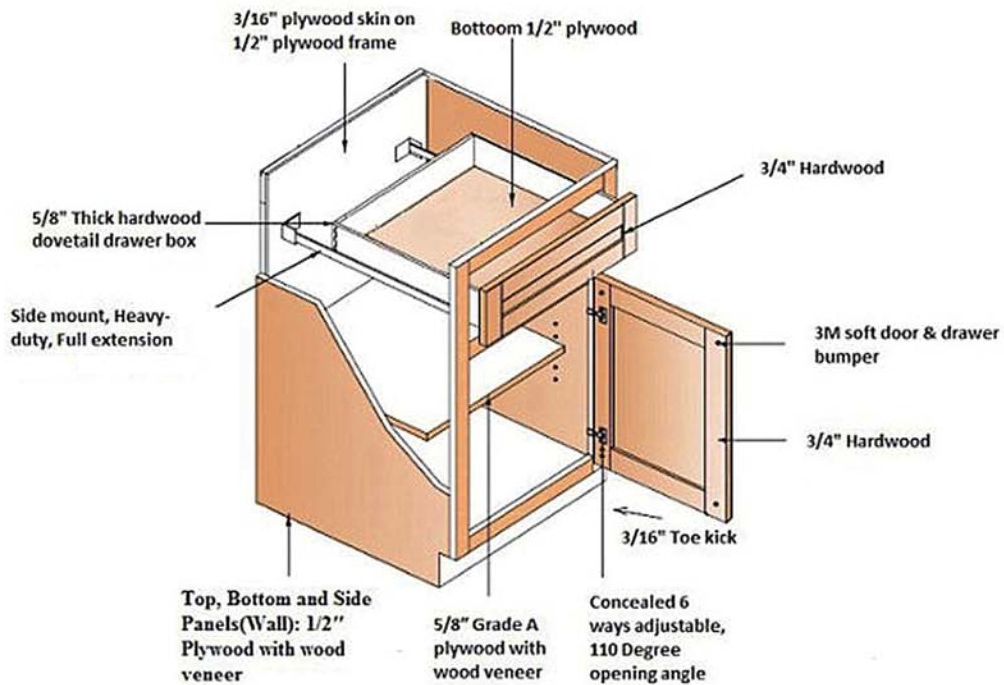

# CABINETS-SPECIFICATION BOOK

## BASE CABINETS

### BASE CABINET-1 DRAWER, 1 DOOR, 1 ADJUSTABLE SHELF

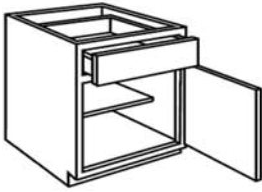
		ITEM CODE	WIDTH	HEIGHT	DEPTH
		B09	9"	34½"	24"
		B12	12"	34½"	24"
		B15	15"	34½"	24"
		B18	18"	34½"	24"
		B21	21"	34½"	24"

### BASE CABINET-1 DRAWER, 2 DOOR, 1 ADJUSTABLE SHELF

		ITEM CODE	WIDTH	HEIGHT	DEPTH
		B24	24"	34½"	24"
		B27	27"	34½"	24"
		B30	30"	34½"	24"

### BASE CABINET- 2 DRAWER, 2 DOOR, 1 ADJUSTABLE SHELF

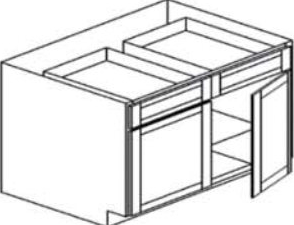
		ITEM CODE	WIDTH	HEIGHT	DEPTH
		B33	33"	34½"	24"
		B36	36"	34½"	24"
		B39	39"	34½"	24"
		B42	42"	34½"	24"

### BASE DRAWER CABINET-3 DRAWERS

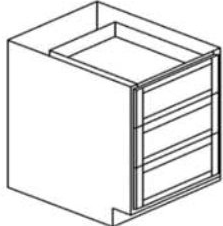
		ITEM CODE	WIDTH	HEIGHT	DEPTH
		DB12	12"	34½"	24"
		DB15	15"	34½"	24"
		DB18	18"	34½"	24"
		DB24	24"	34½"	24"
		DB30	30"	34½"	24"

### SINK BASE CABINET-2 DUMMY DRAWERS, 2 DOORS

		ITEM CODE	WIDTH	HEIGHT	DEPTH
		SB36	36"	34½"	24"
		SB42	42"	34½"	24"

**WASTE BASKET CABINET-1 DRAWER, 1 PULL-OUT DOOR**

		ITEM CODE	WIDTH	HEIGHT	DEPTH
		BWBKT18	18"	34½"	24"

**LAZY SUSAN-2 FULL HEIGHT FOLDING DOORS**

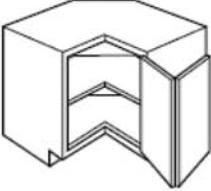
		ITEM CODE	WIDTH	HEIGHT	DEPTH
		LZS3312	33"	34½"	24"
		LZS3612	36"	34½"	24"

**BASE BLIND CORNER CABINET**

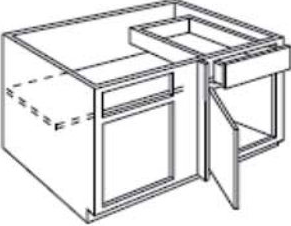
		ITEM CODE	WIDTH	HEIGHT	DEPTH
		BBC36	36"	34½"	24"
		BBC42	42"	34½"	24"

PLEASE NOTE: 3" PULL FROM WALL REQUIRED

**BASE SPICE RACK CABINET-1 FULL HEIGHT DOOR(PULL-OUT), 3 FIXED SHELF**

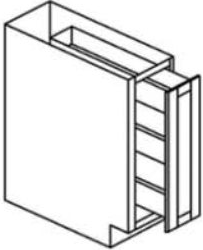
		ITEM CODE	WIDTH	HEIGHT	DEPTH
		SP09	9"	34 1/2 "	24"

**BASE END OPEN SHELF-3 FIXED SHELF**

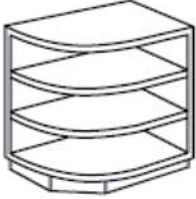
		ITEM CODE	WIDTH	HEIGHT	DEPTH
		BES09	9"	34 1/2 "	24"

**BASE END CORNER**

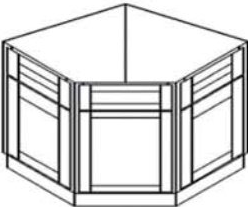
		ITEM CODE	WIDTH	HEIGHT	DEPTH
		BEC	24"	34 1/2 "	24"

# WALL CABINETS

## WALL CABINET-1 DOOR, 2 ADJUSTABLE SHELVES

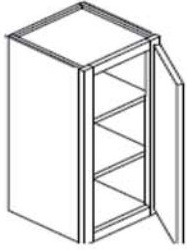

ITEM CODE	WIDTH	HEIGHT	DEPTH
W0930	9"	30"	12"
W1230	12"	30"	12"
W1530	15"	30"	12"
W1830	18"	30"	12"
W2130	21"	30"	12"

## WALL CABINET- 2 DOORS, 2 ADJUSTABLE SHELVES

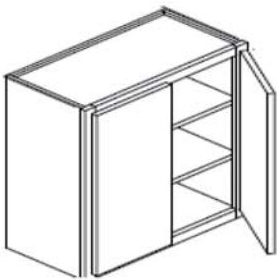

ITEM CODE	WIDTH	HEIGHT	DEPTH
W2430	24"	30"	12"
W2730	27"	30"	12"
W3030	30"	30"	12"
W3330	33"	30"	12"
W3630	36"	30"	12"
W3930	39"	30"	12"
W4230	42"	30"	12"

## WALL CABINET - 1 DOOR, 3 ADJUSTABLE SHELVES

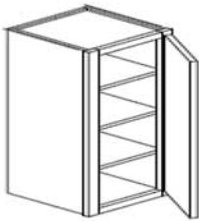

ITEM CODE	WIDTH	HEIGHT	DEPTH
W0936	9"	36"	12"
W1236	12"	36"	12"
W1536	15"	36"	12"
W1836	18"	36"	12"
W2136	21"	36"	12"

## WALL CABINET- 2 DOORS, 3 ADJUSTABLE SHELVES

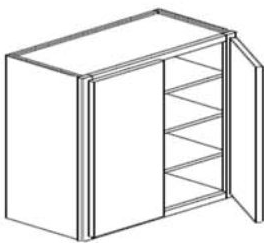

ITEM CODE	WIDTH	HEIGHT	DEPTH
W2442	24"	42"	12"
W2742	27"	42"	12"
W3042	30"	42"	12"
W3342	33"	42"	12"
W3642	36"	42"	12"
W3942	39"	42"	12"
W4242	42"	42"	12"

## WALL CABINET - 2 DOORS, NO SHELF

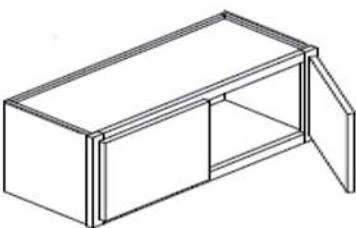

ITEM CODE	WIDTH	HEIGHT	DEPTH
W3012	30"	12"	12"
W3015	30"	15"	12"
W3018	30"	18"	12"
W3612 27	36"	12"	27"
W3615 27	36"	15"	27"
W3618 27	36"	18"	27"

**WALL CABINET - 2 DOORS, 1 ADJUSTABLE SHELF**

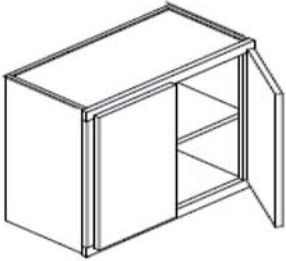
				
	<b>ITEM CODE</b>	<b>WIDTH</b>	<b>HEIGHT</b>	<b>DEPTH</b>
	W3024	30"	24"	12"
	W3624 27	36"	24"	27"

**WALL DIAGONAL CORNER - 1 DOOR, 2 ADJUSTABLE SHELVES**

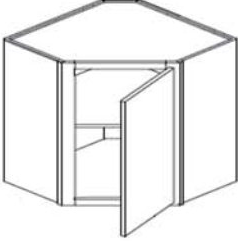
				
	<b>ITEM CODE</b>	<b>WIDTH</b>	<b>HEIGHT</b>	<b>DEPTH</b>
	WDC243012	24"	30"	12"
	WDC243615	24"	36"	12"

**WALL DIAGONAL CORNER - 1 DOOR, 3 ADJUSTABLE SHELVES**

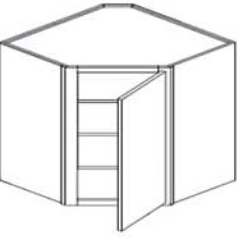
				
	<b>ITEM CODE</b>	<b>WIDTH</b>	<b>HEIGHT</b>	<b>DEPTH</b>
	WDC244215	24"	42"	15"

**STEM GLASS HOLDER**

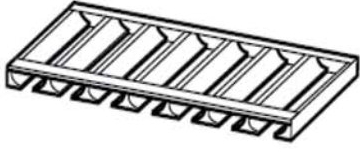
	<b>ITEM CODE</b>	<b>WIDTH</b>	<b>DEPTH</b>	
	GH30	30"	12"	
	GH36	36"	12"	

**WALL WINE RACK**

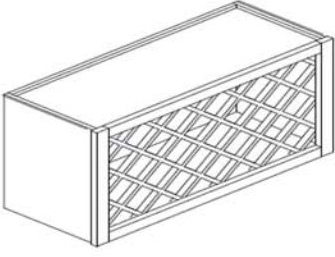
	<b>ITEM CODE</b>	<b>WIDTH</b>	<b>HEIGHT</b>	<b>DEPTH</b>
	WRC3018	30"	18"	12"
	WRC3618	36"	18"	12"

**WALL OPEN END SHELF - NO DOOR, 2 FIXED SHELVES**

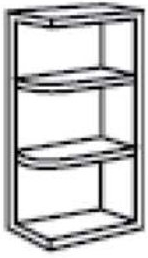

ITEM CODE	WIDTH	HEIGHT	DEPTH
WEOS930	9"	30"	12"
WEOS936	9"	36"	12"

**WALL OPEN END SHELF - NO DOOR, 3 FIXED SHELVES**



ITEM CODE	WIDTH	HEIGHT	DEPTH
WOES942	9"	42"	12"

**WALL END CORNER- 2 DOORS, 2 SHELVES**

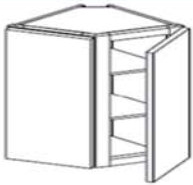

ITEM CODE	WIDTH	HEIGHT	DEPTH
WEC1230	12"	30"	12"
WEC1236	12"	36"	12"

**WALL END CORNER- 2 DOORS, 3 SHELVES**



ITEM CODE	WIDTH	HEIGHT	DEPTH
WEC1242	12"	42"	12"

**WALL MICROWAVE CABINET**

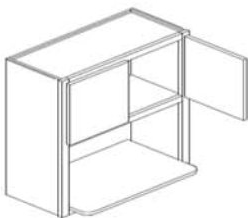

OPENING IS 24" x 15.5"

ITEM CODE	WIDTH	HEIGHT	DEPTH
WMC2730	27"	30"	12"
WMC2736	27"	36"	12"
WMC2742	27"	42"	12"

Bottom shelf depth is 18 1/4"



**GLASS DOOR WITH MULLIONS**

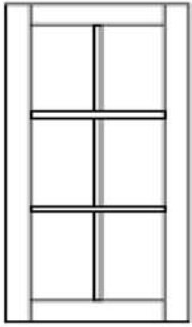

ITEM CODE	WIDTH	HEIGHT	THICKNESS
WG1230	12"	30"	3/4 "
WG1530	15"	30"	3/4 "
WG1830	18"	30"	3/4 "
WG1236	12"	36"	3/4 "
WG1536	15"	36"	3/4 "
WG1836	18"	36"	3/4 "
WG1242	12"	42"	3/4 "
WG1542	15"	42"	3/4 "
WG1842	18"	42"	3/4 "
WDCG243012*	15"	30	3/4 "
WDCG243615	12 3/4"	36	3/4 "
WDCG244215	12 3/4"	42	3/4 "

# TALL CABINETS

**TALL PANTRY, 1 UPPER DOOR AND 1 LOWER DOOR**

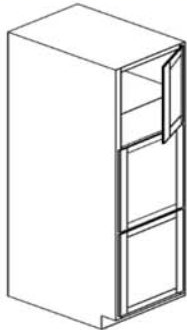

ITEM CODE	WIDTH	HEIGHT	DEPTH
WP1884	18"	84"	27"
WP1890	18"	90"	27"
WP1896	18"	96"	27"

**TALL PANTRY - 2 UPPER DOORS AND 2 LOWER DOORS**



ITEM CODE	WIDTH	HEIGHT	DEPTH
WP2484	24"	84"	27"
WP2490	24"	90"	27"
WP2496	24"	96"	27"

**DOUBLE OVEN CABINET - 2 UPPER DOORS AND 1 LOWER DRAWER**

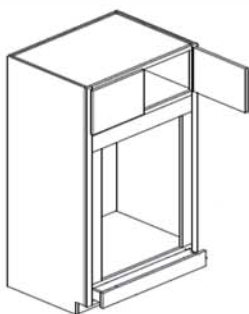

ITEM CODE	WIDTH	HEIGHT	DEPTH
OVD308427	30"	84"	27"
OVD309027	30"	90"	27"
OVD309627	30"	96"	27"
OVD338427	33"	84"	27"
OVD339027	33"	90"	27"
OVD339627	33"	96"	27"

# VANITY CABINETS

## VANITY DRAWER BASE CABINET - 3 DRAWERS

		ITEM CODE	WIDTH	HEIGHT	DEPTH
		VDB12	12"	34 1/2 "	21"
		VDB15	15"	34 1/2 "	21"
		VDB18	18"	34 1/2 "	21"

## VANITY SINK BASE CABINET - 1 DUMMY DRAWER, 2 DOORS

		ITEM CODE	WIDTH	HEIGHT	DEPTH	
		VAN24	24"	34 1/2 "	21"	
		VAN30	30"	34 1/2 "	21"	

## VANITY SINK BASE CABINET - 1 DUMMY DRAWER, 2 DRAWERS, 1 DOOR

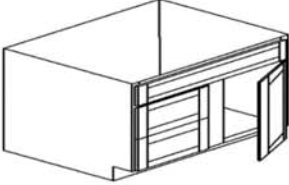
	DRAWERS ON THE LEFT, DOORS ON THE RIGHT	ITEM CODE	WIDTH	HEIGHT	DEPTH		
			VAN30DL	30"	34 1/2 "	21"	

## VANITY SINK BASE CABINET - 1 DUMMY DRAWER, 2 DRAWERS, 1 DOOR

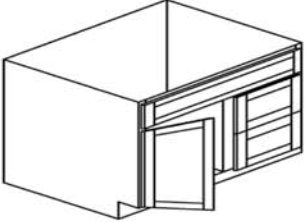
	DRAWERS ON THE RIGHT, DOORS ON THE LEFT	ITEM CODE	WIDTH	HEIGHT	DEPTH		
			VAN30DR	30"	34 1/2 "	21"	

## VANITY SINK BASE CABINET - 2 DUMMY DRAWER, 2 DRAWERS, 1 DOOR

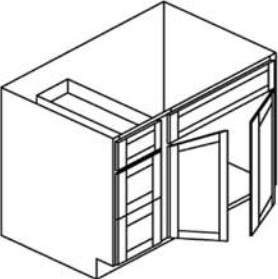
	DRAWERS ON THE LEFT, DOORS ON THE RIGHT	ITEM CODE	WIDTH	HEIGHT	DEPTH		
			VAN36DL	36"	34 1/2 "	21"	

**VANITY SINK BASE CABINET - 2 DUMMY DRAWER, 2 DRAWERS, 1 DOOR**

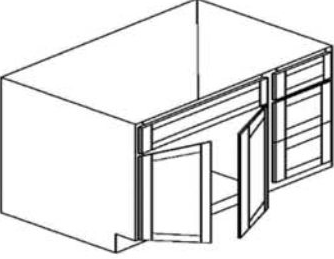
	DRAWERS ON THE RIGHT, DOORS ON THE LEFT	ITEM CODE	WIDTH	HEIGHT	DEPTH
		VAN36DR	36"	34 1/2 "	21"

**VANITY SINK BASE CABINET - 6 DRAWERS, 2 DOORS, 1 DUMMY DRAWER**

	FOR SINGLE SINK	ITEM CODE	WIDTH	HEIGHT	DEPTH
		VAN48D-6	48"	34 1/2 "	21"
		VAN60D-6	60"	34 1/2 "	21"

**VANITY SINK BASE CABINET - 3 DRAWERS, 4 DOORS**

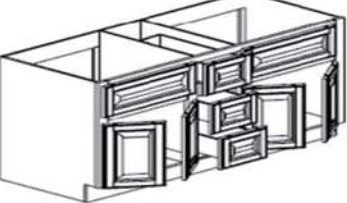
	FOR DOUBLE SINKS	ITEM CODE	WIDTH"	HEIGHT"	DEPTH"
		VAN60DD-3	60"	34 1/2 "	21"
		VAN72DD-3	72"	34 1/2 "	21"

# PRODUCT GUIDE-ACCESSORY

**WALL DECORATIVE DOOR**

		WIDTH	HEIGHT	THICKNESS
	<b>WDD30</b>	11"	29 1/4"	3/4"
	<b>WDD36</b>	11"	35 1/4"	3/4"
	<b>WDD42</b>	11"	41 1/4"	3/4"

**BASE DECORATIVE DOOR**

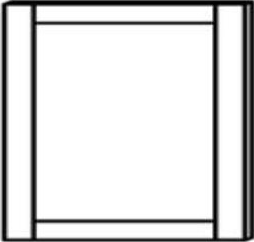
		WIDTH	HEIGHT	THICKNESS
	<b>BDD24</b>	23"	29 1/4"	3/4"

**WALL FILLER**

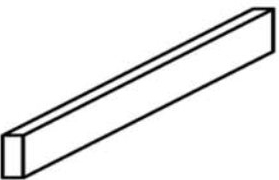
			<b>WIDTH</b>	<b>HEIGHT</b>	<b>THICKNESS</b>
		<b>WF3 30</b>	3"	30"	3/4"
		<b>WF3 36</b>	3"	36"	3/4"
		<b>WF3 42</b>	3"	42"	3/4"
		<b>FILLER 3*96</b>	3"	96"	3/4"
		<b>FILLER 6*96</b>	6"	96"	3/4"

**FLUTED FILLER**

			<b>WIDTH</b>	<b>HEIGHT</b>	<b>THICKNESS</b>
		<b>FFWF3 96</b>	3"	96"	3/4"

**BASE FILLER**

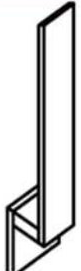
	FILLER INCLUDES 4" TOE KICK		<b>WIDTH</b>	<b>HEIGHT</b>	<b>THICKNESS</b>	
			<b>BF3</b>	3"	34½"	3/4"
			<b>BF6</b>	6"	34½"	3/4"

**DISHWASHER PANEL**

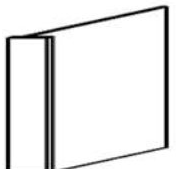
	FRONT FILLER: 3"x34.5" x 3/4"		<b>WIDTH</b>	<b>HEIGHT</b>	<b>DEPTH</b>	
			<b>DWP3</b>	3"	34½"	24"

**REFRIGERATOR PANEL,**

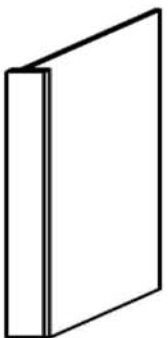
	FRONT FILLER: 3" x3/4" x96"		<b>DEPTH</b>	<b>HEIGHT</b>	<b>THICKNESS</b>	
			<b>RRP24</b>	24"	96	1/2"
			<b>RRP27</b>	27"	96	1/2"

**ROYAL CROWN MOLDING**

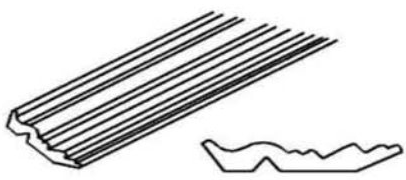
		<b>WIDTH</b>	<b>LENGTH</b>		
		<b>CCM8</b>	4.5"	96"	
		<b>ACM8</b>	2.5"	96"	

**BASE FILLER**

	FILLER INCLUDES 4" TOE KICK		<b>WIDTH</b>	<b>HEIGHT</b>	<b>THICKNESS</b>
		<b>BF3</b>	3"	34½"	3/4"
		<b>BF6</b>	6"	34½"	3/4"

**DISHWASHER PANEL**

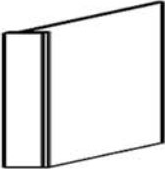
	FRONT FILLER: 3"x34.5" x 3/4"		<b>WIDTH</b>	<b>HEIGHT</b>	<b>DEPTH</b>
		<b>DWP3</b>	3"	34½"	24"

**REFRIGERATOR PANEL,**

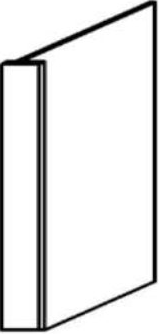
	FRONT FILLER: 3" x3/4" x96"		<b>DEPTH</b>	<b>HEIGHT</b>	<b>THICKNESS</b>
		<b>RRP24</b>	24"	96	1/2"
		<b>RRP27</b>	27"	96	1/2"

**ROYAL CROWN MOLDING**

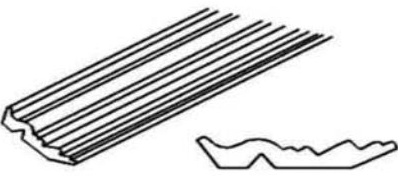
		<b>WIDTH</b>	<b>LENGTH</b>
	<b>CCM8</b>	4.5"	96"
	<b>ACM8</b>	2.5"	96"

**BASEMOLDING**

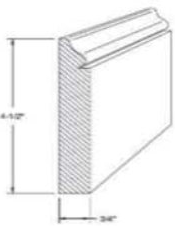
		<b>WIDTH</b>	<b>THICKNESS</b>	<b>LENGTH</b>
	<b>BASE MOLDING</b>	4.5"	3/4"	96"

**OUTSIDE CORNER MOLDING**

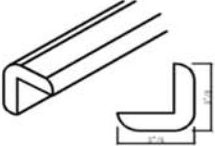
		<b>WIDTH</b>	<b>HEIGHT</b>	<b>LENGTH</b>
	<b>ANGLE MOLDING</b>	3/4"	3/4"	96"

**INSIDE CORNER MOLDING**

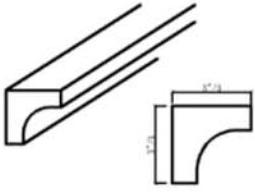
		INSIDE CORNER MOLDING	WIDTH	HEIGHT	LENGTH
			3/4"	3/4"	96"

**SHOEMOLDING**

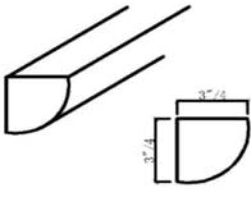
		SHOEMOLDING	WIDTH	HEIGHT	LENGTH
			3/4"	3/4"	96"

**SCRIBEMOLDING**

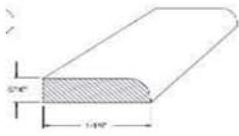
		SCRIBEMOLDING	WIDTH	LENGTH	THICKNESS
			3/4"	96"	1/4"

**LIGHT RAIL MOLDING**

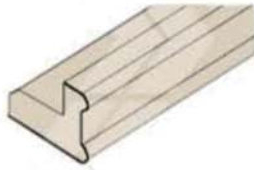
		TLR8	WIDTH	LENGTH	DEPTH
			1 3/8"	96"	2"

**DECORATIVE FILLER**

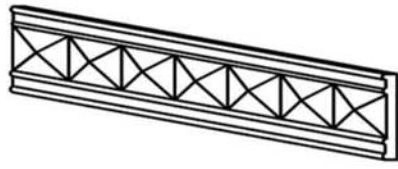
		LMD	WIDTH	LENGTH	THICKNESS
			4"	96"	7/8"

**DECORATIVE FILLER**

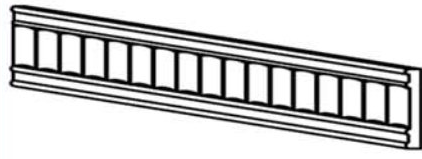
		LMW	WIDTH	LENGTH	THICKNESS
			4"	96"	7/8"

**VALANCE**

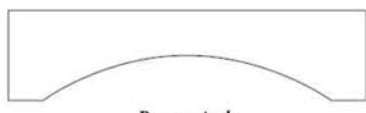
 <p>Roman Arch</p>	<p>NOTE: NARROWEST PART IS 3.5", WIDEST IS 6"</p>	VAL36	WIDTH	HEIGHT	THICKNESS
			36"	6"	3/4"
		VAL42	42"	6"	3/4"
		VAL48	48"	6"	3/4"

**DECORATIVE VALANCE**

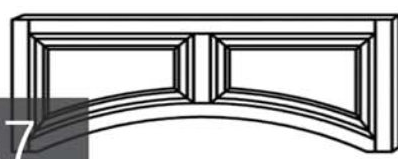
	<p>NOTE: NARROWEST PART IS 11", WIDEST IS 15"</p>	RPV30	WIDTH	HEIGHT	THICKNESS
			30"	15"	3/4"
		RPV36	36"	15"	3/4"
		RPV42	42"	15"	3/4"
		RPV48	48"	15"	3/4"

**SKIN PANEL**

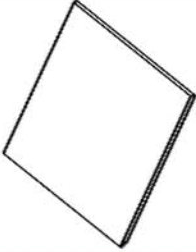
			<b>WIDTH</b>	<b>LENGTH</b>	<b>THICKNESS</b>
		<b>PANEL 36*96</b>	<b>36"</b>	<b>96"</b>	<b>1/8"</b>
		<b>PANEL 48*96</b>	<b>48"</b>	<b>96"</b>	<b>1/8"</b>

**SAMPLE DOOR**

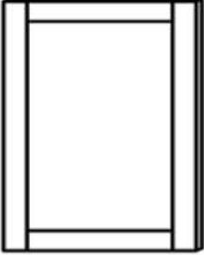
			<b>WIDTH</b>	<b>HEIGHT</b>	<b>THICKNESS</b>
		<b>SAMPLE DOOR LARGE</b>	<b>11½"</b>	<b>15"</b>	<b>3/4"</b>

**DENTALMOLDING**

			<b>WIDTH</b>	<b>LENGTH</b>	<b>THICKNESS</b>
		<b>DENTALMOLDING</b>	<b>1"</b>	<b>96"</b>	<b>3/4"</b>

**ROPEMOLDING**

			<b>WIDTH</b>	<b>LENGTH</b>	<b>THICKNESS</b>
		<b>ROPEMOLDING</b>	<b>1"</b>	<b>96"</b>	<b>3/4"</b>

**TOE KICK**

			<b>WIDTH</b>	<b>LENGTH</b>	<b>THICKNESS</b>
		<b>TK8(5MM)</b>	<b>4½"</b>	<b>96"</b>	<b>3/16"</b>
		<b>TK8(12MM)</b>	<b>4½"</b>	<b>96"</b>	<b>3/4"</b>

**CORBEL 6"**

			<b>WIDTH</b>	<b>HEIGHT</b>	<b>DEPTH</b>
		<b>CORBEL 6"</b>	<b>6"</b>	<b>10"</b>	<b>3 3/4"</b>

**ROSETTE BLOCK**



		WIDTH	HEIGHT	THICKNESS
	<b>ROSETTE 3*3</b>	3"	3"	3/4"

**TURN POST**



		WIDTH	DEPTH	HEIGHT
	<b>DLS4*4*34.5</b>	4"	4"	34½"

**PULL OUT TRAY**



		WIDTH	DEPTH	HEIGHT
	<b>PULL OUT TRAY 18"</b>	18"	21"	4"
	<b>PULL OUT TRAY 24"</b>	24"	21"	4"
	<b>PULL OUT TRAY 30"</b>	30"	21"	4"





# ISLAND POST OPTIONS



1403

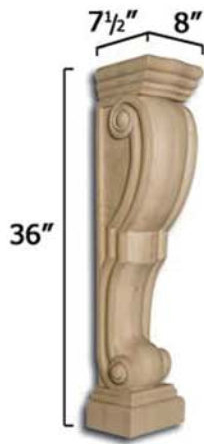

1425



1436



1505



1445



1450



1487



3501



3512



3513

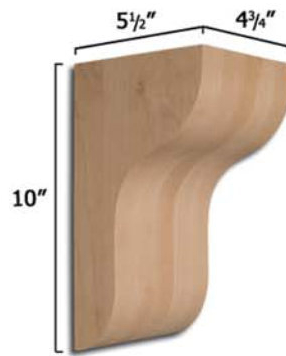

8018



8083

# ISLAND POST OPTIONS



8100

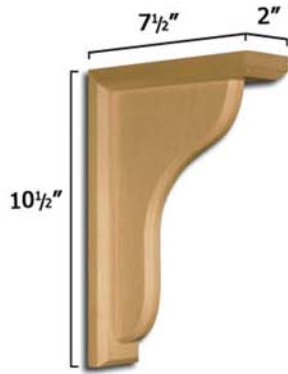

8729

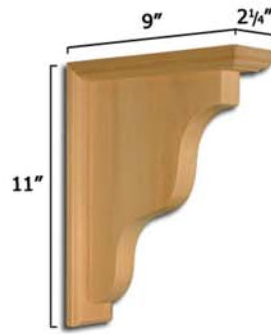

8730

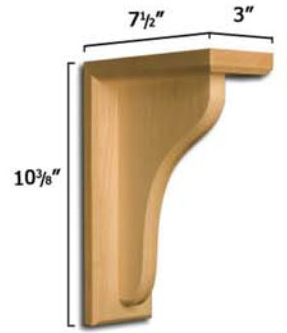

1505

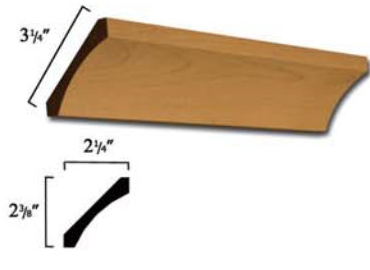

76431

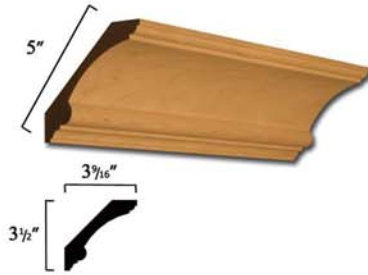

74651-1

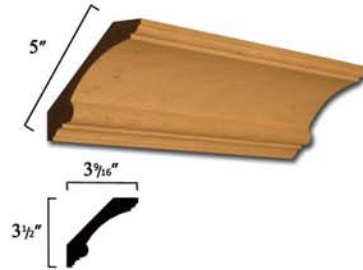

1487

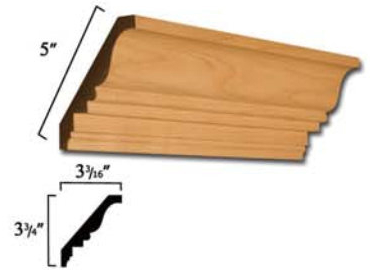

74653

# ISLAND POST OPTIONS

